



783 County Road 377  
Cleveland, Tx 77327

# SAN JACINTO HORSE SHOW ASSOCIATION

RECOGNIZED HORSE SHOW  
TO BE HELD AT

# Fairview Farm

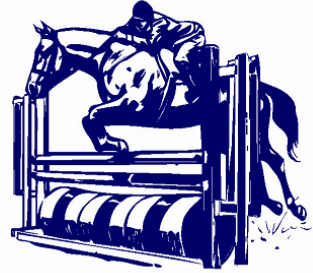

August 7<sup>th</sup> and 8<sup>th</sup> 2010  
Starting at 8:30 am (Sat.)  
8:00 am (Sun)

Fairview Farm  
783 County Road 377  
Cleveland, Tx 77327

# GENERAL INFORMATION

<b>Manager:</b>	Haike deLeyer
<b>Ring Committee:</b>	S.J.S.H.A. Directors
<b>Judges:</b>	Meg Pringle, TBA
<b>Secretary:</b>	Amy Thompson
<b>Location:</b>	Fairview Farm 783 County Road Cleveland, Tx 77327 (281) 659-2801 – farm (281) 806-1956 – cell phone
<b>Entry Fees:</b>	\$15.00 per class
<b>Coggins:</b>	Every horse on show grounds must have a current negative coggins within 12 months.
<b>Concessions:</b>	Sunday only
<b>Photographer:</b>	Jim Stoner
<b>Hard Hats:</b>	must be worn when mounted
<b>Equipment:</b>	Martingales are not allowed in flat classes. Polo Wraps are allowed in equitation and jumper classes only. Bell boots are not allowed in hunter or equitation classes unless approved by Show Manager and Directors (i.e. inclement weather).
<b>Membership:</b>	For a fee of \$15.00 per year riders (\$1.00 per horse) may become a member of S.J.S.H.A. to receive points towards year end awards. (Applications available)

*Entries must be paid by open check prior to issuing number*

Fairview Farm, Haike deLeyer, and the S.J.H.S.A. reserve the right to interpret all questions and conditions in regard to or arising from any incident during the show without claims, damages or recourse of any kind. All questions not covered in the rule regulations shall be decided by the show committee; their decision is final.

The horse show committee reserves the right to refuse, accept conditionally, or to cancel any awards without claim for damages. It also reserves the right to change or substitute changes to combine any unfilled classes.

**Condition of Entry:** Every horse entered for competition will be under the control of the Show Manager, but Fairview Farm, Haike deLeyer, nor the S.J.H.S.A. in no case will be responsible for any loss or damage which occur to negligence on behalf of Fairview Farm, Haike deLeyer, or S.J.H.S.A.

# DIVISION SPECIFICATIONS

*WALK/TROT EQUITATION* – No cross entries into any other divisions.

*PRE-BEGINNER EQUITATION* – fences 18". Trot or canter four fences. For riders who have not won six blue ribbons at any show over fences. No cross entries.

*BEGINNER EQUITATION* – Fences 2'. No cross entries except pony division. For riders who have not shown over 2'. Top six year-end award winners must advance. Riders are eligible for entire show year.

*ADULT BEGINNER EQUITATION* – Fences up to 2'. Open to adults over 18 years of age who have not shown over 2'. Riders are eligible for entire show year.

*NOVICE EQUITATION* – Fences 2'3". For riders who have not shown over 2'6". Top six year-end winners must advance. Riders are eligible for entire show year.

*LIMIT HUNTER & EQUITATION* – Fences 2'6". For riders who have not shown over 2'9" at any show. Riders are eligible for entire show year.

*ADULT NOVICE* - Fences 2' - 2'3". Open to adult riders over 25 years who are not competing in any other division. Points awarded as a horse and rider combination.

*BABY GREEN HUNTER* – Fences 2' - 2'6". Open to horses and ponies for 2009 year only. No cross entries over 2'6".

*PONY HUNTER EQUITATION* – Fences 2' - 2'3". Open to ponies 14.2 and under, ridden by junior riders. No in and outs.

*SCHOOLING HUNTER* – Fences 2'6". Open to all.

*JUNIOR/ADULT HUNTER & EQUITATION* – Fences 2'9". Open to junior and amateur adults.

*TRAINING JUMPER* – Fences 2'6". No cross entries. Once a rider moves up they cannot move back to training jumper without directors approval.

*SCHOOLING JUMPER* – Fences 2'9" - 3'. Open to all. No cross entries.

*OPEN JUMPER* - Fences 3'3" - 3'6" to start. Open to all.

# TENTATIVE SCHEDULE

## Saturday - Ring I - 8:30am

1. Training Jmpr - touch & time
2. Training Jmpr - P&S
3. Training Jmpr - TFR\*
4. Schooling Jmpr - touch & time
5. Schooling Jmpr - P&S
6. Schooling Jmpr - TFR\*
7. Open Jmpr - touch & time
8. Open Jmpr - P&S
9. Open Jmpr - TFR\*

\*Stake Class - must enter two other classes to enter

## Sunday - Ring I - 8:00am

10. Warm Up
11. Adult Novice Hntr U/S
12. Adult Novice Eq. Flat
13. Adult Novice Hntr O/F
14. Adult Novice Eq. O/F
15. Baby Green Hntr O/F
16. Baby Green Hntr O/F
17. Baby Green Hntr U/S
18. Novice Equitation O/F
19. Novice Equitation O/F
20. Novice Equitation Flat
21. Warm Up
22. Schooling Hunter O/F
23. Schooling Hunter O/F
24. Schooling Hunter U/S
25. Limit Hunter O/F
26. Limit Hunter O/F
27. Limit Equitation O/F
28. Limit Hunter U/S
29. Limit Equitation Flat
30. Junior/Adult Hntr O/F
31. Junior/Adult Hntr O/F
32. Junior/Adult Eq. O/F
33. Junior/Adult Hntr U/S
34. Junior/Adult Eq. Flat

## Sunday - Ring II - 8:00am

35. Warm Up
36. Pony Hunter O/F
37. Pony Hunter O/F
38. Pony Equitation O/F
39. Pony Hunter U/S
40. Pony Equitation Flat
41. Adult Beginner W/T
42. Adult Beginner W/T/C
43. Adult Beginner Eq. O/F
44. Adult Beginner Eq. O/F
45. Beginner Eq. O/F
46. Beginner Eq. O/F
47. Beginner Eq. W/T/C
48. Pre-Beginner Eq. W/T
49. Pre-Beginner Eq. W/T/C
50. Pre-Beginner Eq. O/F
51. Pre-Beginner Eq. O/F
52. Walk/Trot Equitation
53. Walk/Trot Fig. Eight
54. Walk/Trot Poles

**RING I TAKES PRIORITY**

# DIRECTIONS TO FAIRVIEW FARM

From Hwy 1488 or 45 N: Take hwy 242 traveling east. Merge onto US-59 N via the ramp on the left. Travel approximately 7 miles (pass Anderson Ford and the John Deere dealership), turn right on County Road 383. Cross the railroad tracks. Follow this road until you must turn left onto County Road 377, follow the curve road approx 1 mile- Fairview Farm is on the right directly after the road curves to the left.

From Hwy 105: Take Hwy 105 traveling east. Turn right on US-59 S. Travel approximately 2 miles, turn left (crossing US-59 N and the railroad tracks) onto County Road 383. Follow this road until you must turn left onto County Road 377, follow the curve road approx 1 mile - Fairview Farm is on the right directly after the road curves to the left.

Trailer parking - use 2<sup>nd</sup> entrance  
Car parking - 1<sup>st</sup> entrance

*Note: All big trailers please call Haike for parking information*

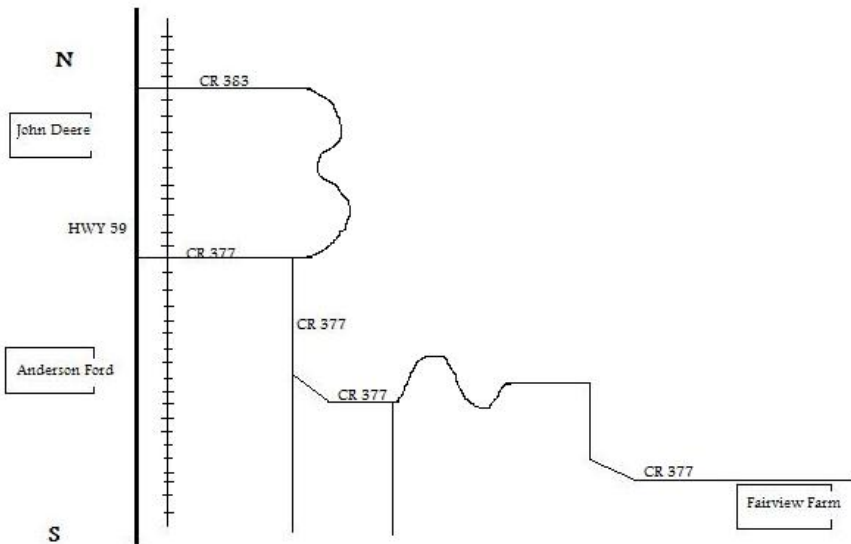

# PRIZE MONEY!!

**Saturday, August 7<sup>th</sup>:** Classes 3, 6 & 9 are stake classes. Winner takes all. You must enter two other classes to enter the stake class.

**Sunday, August 8<sup>th</sup>:** \$100.00 Trainer Award

The Trainer Award will be awarded to the trainer with the most points accumulated by their riders during the show on Sunday only, so pack your trailers and get your entries in!

Trainers must keep their own points to be verified at the secretary stand.

Points are as follows:

5 points: 1st Place

3 points: 2nd Place

2 points: 3rd Place

1 point: 4th Place

10 points: Champion

5 points: Reserve Champion

# GOOD LUCK TO ALL AND HAVE FUN!!

# Misc. Information

Please fax your entries by Friday, August 6<sup>th</sup> to Amy Thompson at **281-360-7420**

Note: All dogs must be on a leash

**Thank you to Jim Stoner for being our photographer this weekend. Be sure to check out your photos at [www.photorelect.com](http://www.photorelect.com)**

**Fairview Farm would like to thank the following for their sponsorship:**

- **WILD BILL'S WELDING**
  - **HI-TECH FARM**
- **HOLLANDIA FARMS**

**A special thanks goes to the Thompson and the Hord family for all their help and hard work!**

\*\*\*\*\*WARNING\*\*\*\*\*

*UNDER TEXAS LAW (CHAPTER 87, CIVIL PRACTICE AND REMEDIES CODE) AN EQUINE PROFESSIONAL IS NOT LIABLE FOR ANY INJURY TO OR THE DEATH OF A PARTICIPANT IN EQUINE ACTIVITIES RESULTING FROM THE INHERENT RISKS OF EQUINE ACTIVITIES.*